

MAIN FLOOR

884 SQ. FT.

8' CEILING HEIGHT

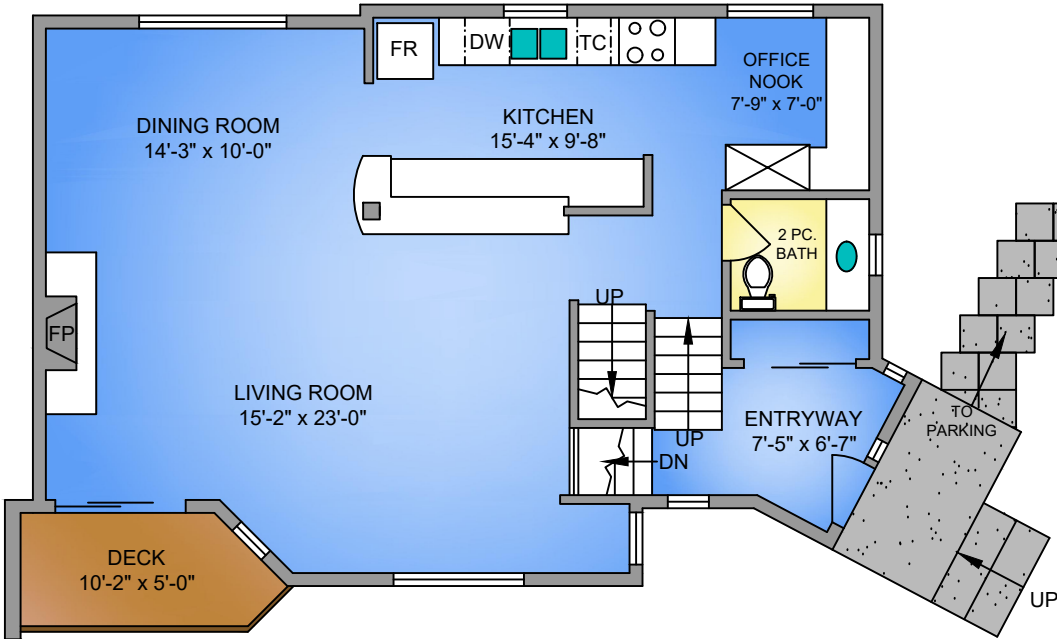

UPPER FLOOR

654 SQ. FT.

8' CEILING HEIGHT

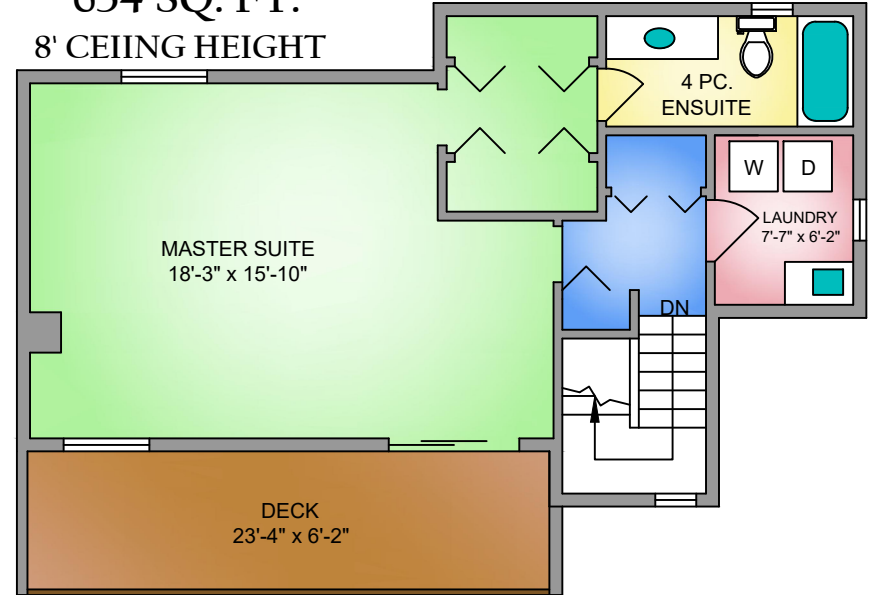

LOWER FLOOR

355 SQ. FT.

8' CEILING HEIGHT

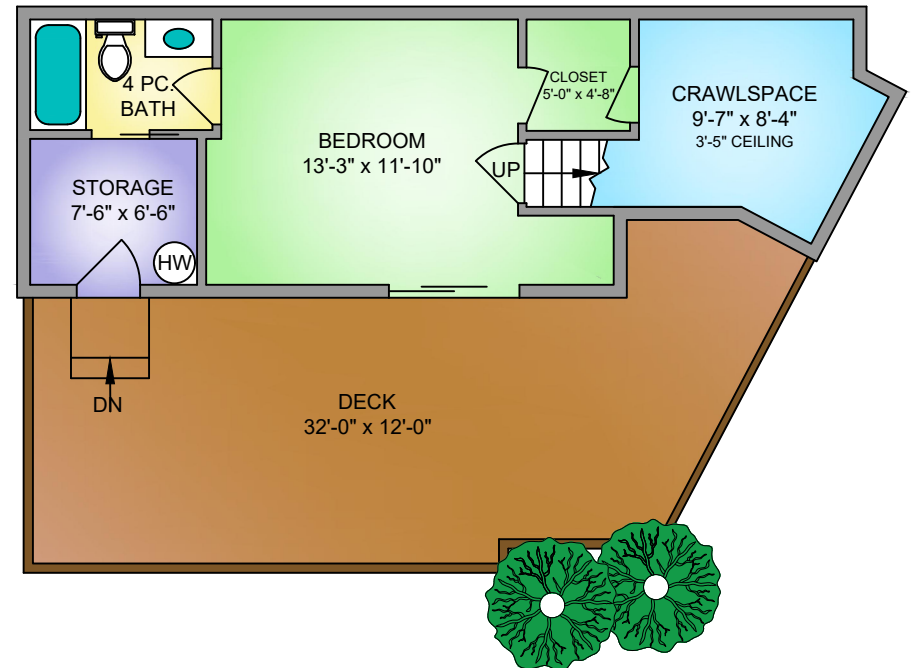

NORTH

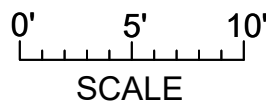
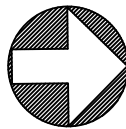

UNIT 5 - 730 SEA TERRACE		
MAY 10, 2019		
PREPARED FOR THE EXCLUSIVE USE OF PROPERTIES IN VICTORIA PROFESSIONALS PLANS MAY NOT BE 100% ACCURATE, IF CRITICAL BUYER TO VERIFY.		
FLOOR	AREA (SQ. FT.)	
	FINISHED	DECK / PATIO
MAIN	884	54
UPPER	654	144
LOWER	355	367
TOTAL	1893	565